

PROPRIETARY NOTICE
 THIS DRAWING CONTAINS CONFIDENTIAL INFORMATION
 TO WHICH PATENT RIGHTS MAY BE ASSERTED. IT IS TO BE KEPT
 UNDER STRICT CONTROL AND IS NOT TO BE REPRODUCED,
 COPIED, LOANED, DISTRIBUTED, OR DISCLOSED IN ANY MANNER
 WITHOUT THE EXPRESS WRITTEN PERMISSION OF BSI.

REVISIONS						
REV	ZONE	ECO #	DESCRIPTION	BY	DATE	APPROVALS

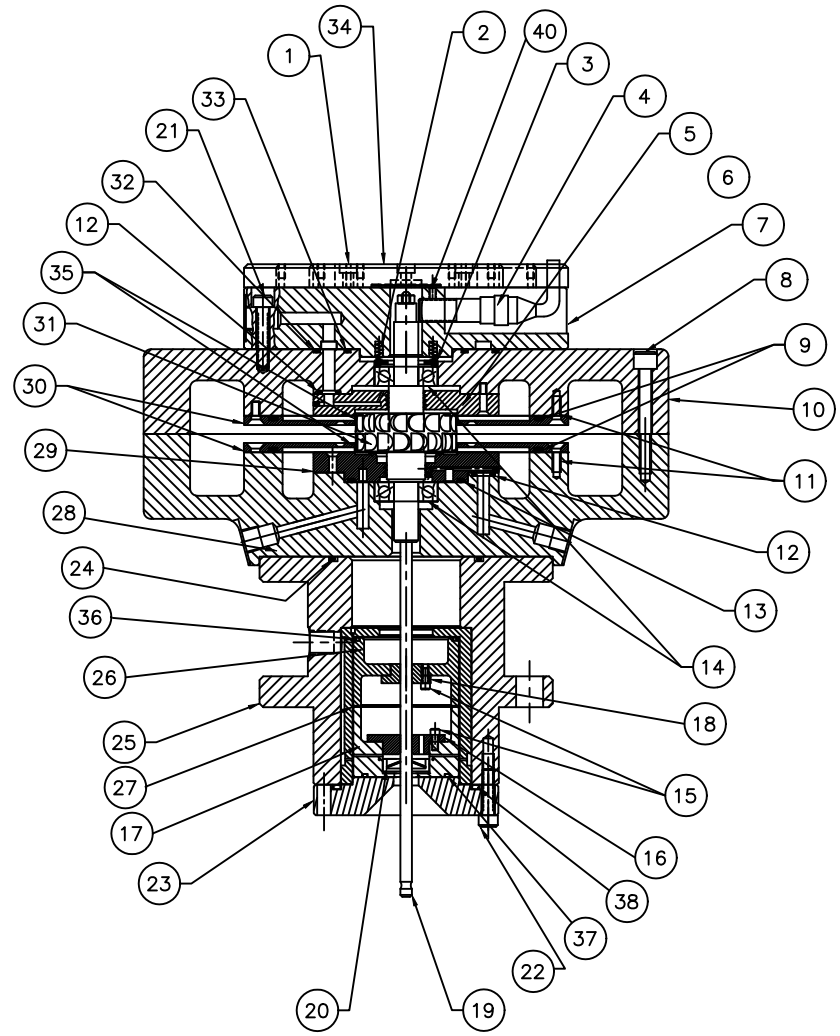

40		2	SET SCREW			
39	10710-628	2	CONNECTOR BASE			
38	2-139 FKM	1	O RING DAMPER END CAP			
37	2-026 FKM	1	O RING DAMPER CUP LOWER			
36	2-029 FKM	1	O RING DAMPER CUP UPPER			
35	140-256-3	24	2-56 X 3/8 LG FLAT HEAD SCREW			
34	2133	1	TOP COVER			
33	2-032	1	O-RING			
32	2-040	1	O-RING, BEARING HOUSING			
31	1505	1	ROTOR ASSEMBLY			
30	1502	2	NOZZLE PLATE			
29	1504	1	LABYRINTH SEAL, LOWER			
28	120X1024-6	6	10-24 X .75 SHCS			
27	10600-515	1	DAMPER SHIM			
26	2175	1	DAMPER CUP UPPER			
25	10600-517	1	DAMPER HOUSING ASSEMBLY REV A			
24	2-140	1	O-RING DAMPER HOUSING TO NB			
23	10600-520	1	DAMPER END CAP			
22	120-1030F6	6	#10-32 X 3/8 SHCS			
21	120X1024-8	8	10-24 X 1" SHCS			
20	3114	1	OIL SEAL			
19	1307RH	1	SPINDLE			
18	1302	1	UPPER DAMPER BUSHING			
17	2176	1	DAMPER CUP LOWER			
16	2543	1	LOWER DAMPER BUSHING			
15	1040	8	3-48 X 1/4 LG SHCS (NYLOK PATCH)			
14	1119C	2	BEARINGS			
13	2-031	1	O-RING			
12	2-009	8	O-RING			
11	140-632-3	14	6-32 X 3/8 LG FLAT HEAD SCREW			
10	1508	1	NOZZLE BOX ASSEMBLY			
9	2-156	2	O-RING			
8	120-1024-12	10	10-24 X 1.5 LG SHCS			
7	2131	1	UPPER COVER			
6	140-440-4	12	4-40 X 1/2 LG FLATHEAD SCREW			
5	1503	1	LABYRINTH SEAL, UPPER			
4	TC-3-30	2	SPEED SENSOR			
3	3105	1	PRESSURE RING			
2	1139	6	SPRING, BEARING PRELOAD			
1		4	6-32 X .50 LG SHCS			
REF NO	PART NO.	QTY	DESCRIPTION			

PARTS LIST		TITLE		REV	
BSI		BARBOUR STOCKWELL INC.		B	
55 SIXTH ROAD		WOBURN, MA, 01801 USA			
AIR TURBINE		1500 RPM			
REV	DESCRIPTION	DATE	BY	APP'D	CHK'D
1	ISSUE	8/05	ME		
2	REVISED	8/05	KM		
3	DESIGNED				
4	DRAWN				
5	CHECKED				
6	APPROVED				
7	DATE				
8	BY				
9	APP'D				
10	CHK'D				
11	SCALE				
12	WT				
13	SHEET				
14	OF				

NOTES:
 1. FOR DISPLAY PURPOSES SOME FEATURES ARE DRAWN OUT OF TRUE POSITION. REFER TO INSTALLATION DRAWING FOR RADIAL ORIENTATIONS.

DO NOT SCALE THIS DRAWING	APPROVALS	DATE	DIMENSIONS ARE IN INCHES
UNSPECIFIED TOL .XX ± .01 .XXX ± .005 .XXXX ± .0005 ANGLES ± 0' 30" RADIUS OR CHAMFER ALL SHARP EDGES .015 MAX. ALL MACHINED SURFACES 63 RMS CONCENTRICITY .005 TIR SURFACE FINISH 1500 Astm MATERIAL: SEE DRAWING HEAT TREAT: NONE	APPROVED: ME CHECKED: KM DESIGNED: - DRAWN: - SURFACE FINISH: N/A OTHER: N/A	8/05 8/05	THIRD ANGLE PROJECTION DIMENSIONS ARE IN INCHES