

PROPORTIONATE NOTICE  
 THIS DRAWING IS THE PROPERTY OF BSI BARBOUR STOCKWELL INC. AND IS NOT TO BE REPRODUCED OR TRANSMITTED IN ANY FORM OR BY ANY MEANS, ELECTRONIC OR MECHANICAL, INCLUDING PHOTOCOPYING, RECORDING, OR BY ANY INFORMATION STORAGE AND RETRIEVAL SYSTEM, WITHOUT THE WRITTEN PERMISSION OF BSI BARBOUR STOCKWELL INC.

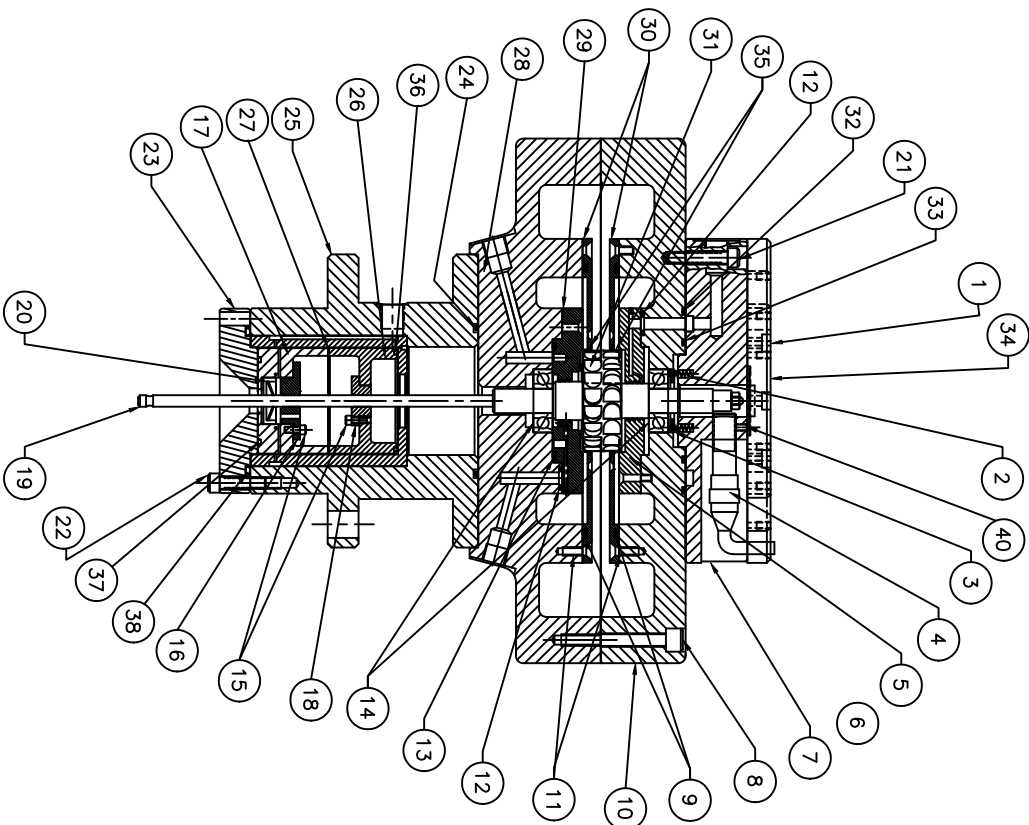

REV	ZONE	ECO #	DESCRIPTION	BY	DATE	APPROVALS
1						
2						

NO	PART NO.	QTY	DESCRIPTION
1	10710-628	2	SET SCREW
2	2-139 FKM	1	O RING DAMPER END CAP
3	2-028 FKM	1	O RING DAMPER CUP LOWER
4	2-029 FKM	1	O RING DAMPER CUP UPPER
5	140-256-3	24	2-56 X 3/8 LG FLAT HEAD SCREW
6	2133	1	TOP COVER
7	2-032	1	O-RING
8	2-040	1	O-RING, BEARING HOUSING
9	1505	1	ROTOR ASSEMBLY
10	1502	2	NOZZLE PLATE
11	1504	1	LABYRINTH SEAL, LOWER
12	120X1024-6	6	10-24 X .75 SHCS
13	10600-515	1	DAMPER SHIM
14	2175	1	DAMPER CUP UPPER
15	10600-517	1	DAMPER HOUSING ASSEMBLY REV A
16	2-140	1	O-RING DAMPER HOUSING TO NB
17	10600-520	1	DAMPER END CAP
18	120-1030F6	6	#10-32 X 3/8 SHCS
19	120X1024-8	8	10-24 X 1" SHCS
20	3114	1	OIL SEAL
21	1307RH	1	SPINDLE
22	1302	1	UPPER DAMPER BUSHING
23	2176	1	DAMPER CUP LOWER
24	2543	1	LOWER DAMPER BUSHING
25	1040	8	3-48 X 1/4 LG SHCS (NLOK PATCH)
26	1119C	2	BEARINGS
27	2-031	1	O-RING
28	2-009	8	O-RING
29	140-632-5	14	6-32 X 3/8 LG FLAT HEAD SCREW
30	1508	1	NOZZLE BOX ASSEMBLY
31	2-156	2	O-RING
32	120-1024-12	10	10-24 X 1.5 LG SHCS
33	4431	1	UPPER COVER
34	140-440-4	12	4-40 X 1/2 LG FLATHEAD SCREW
35	1503	1	LABYRINTH SEAL, UPPER
36	TC-3-30	2	SPEED SENSOR
37	3105	1	PRESSURE RING
38	1139	6	SPRING, BEARING PRELOAD
39	1	4	6-32 X .50 LG SHCS

DO NOT SCALE THIS DRAWING	UNSPECIFIED TOL	APPROVALS	DATE	DIMENSIONS ARE IN INCHES	THIRD ANGLE PROJECTION	SCALE	SHEET NO.	TOTAL SHEETS
XX ± .01 XXX ± .005 XXXX ± .0025 ANGLES ± .02°		DATE: 8/05 BY: [Signature]	8/05			1:500	1	1

**BSI** BARBOUR STOCKWELL INC.  
 50 SOUTH ROAD  
 WOODRUFF, IN, 47881 USA

AIR TURBINE  
 150,000 RPM

NOTES:  
 1. FOR DISPLAY PURPOSES SOME FEATURES ARE DRAWN OUT OF TRUE POSITION. REFER TO INSTALLATION DRAWING FOR RADIAL ORIENTATIONS.