

THIS DRAWING IS THE PROPERTY OF WIPACOR ENGINEERING COMPANY, INC. AND IS NOT TO BE REPRODUCED OR TRANSMITTED IN ANY FORM OR BY ANY MEANS, ELECTRONIC OR MECHANICAL, INCLUDING PHOTOCOPYING, RECORDING, OR BY ANY INFORMATION STORAGE AND RETRIEVAL SYSTEM, WITHOUT THE WRITTEN PERMISSION OF WIPACOR ENGINEERING COMPANY, INC. THE COMPANY SHALL BE RESPONSIBLE FOR ANY CHANGES TO THE DRAWING SINCE THE DATE OF THE ORIGINAL ISSUE.

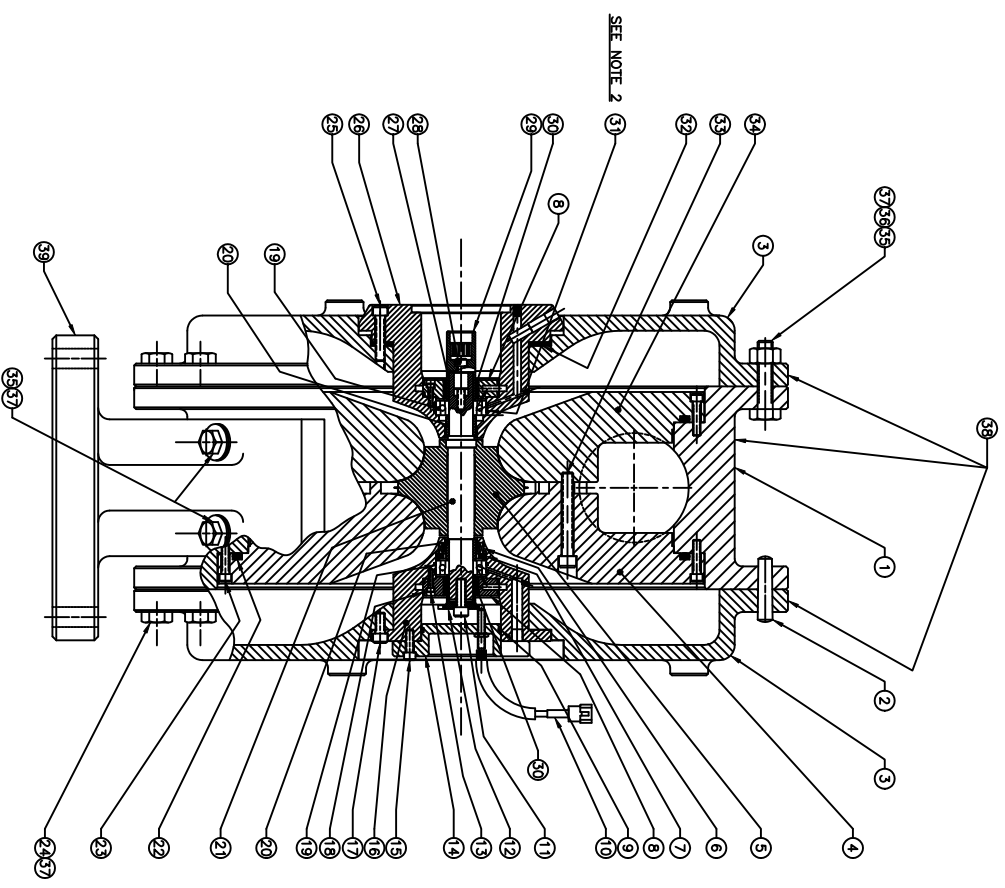

SEE NOTE 2

NOTE ~

1. ITEM #38 CONSISTS OF ITEMS #1 & #3. THESE ITEMS CAN ONLY BE USED AS AN ASSEMBLY.
2. BEARING HOUSINGS ~ ITEMS 16 & 26 HAVE 2 O-RINGS (ITEM 31) PER HSG.

PARTS LIST

REF. NO.	PART NO.	QTY	DESCRIPTION
1	6488-06	1	BASE, SCROLL
2	9435	6	TAPER PIN
3	6488-19	2	EXHAUST HOUSING
4	6488-04	1	SHROUD C.C.W. END
5	6488-02	1	ROTOR
6	9425	21	SPRING, BEARING PRELOAD
7	6488-14	1	PRESSURE RING
8	6488-16	2	OIL FEED
9	9426	1	O-RING, END CAP
10	2942	1	PICK UP ASSEMBLY
11	2449	1	SCREW
12	6488-13	1	SPEED PICKUP GEAR
13	2933	8	SCREW
14	6488-17	1	END CAP
15	4186	4	SCREW
16	6488-09	1	BEARING HOUSING (PICKUP END)
17	9428	4	SCREW
18	9429	4	O-RING, OIL FEED
19	2714-CER	2	BALL BEARING, CERAMIC
20	6488-10	2	LABYRINTH SEAL (BEARING SPACER)
21	6488-07	1	ROTOR SHAFT
22	9430	2	O-RING, SHROUD
23	9431	28	SCREW
24	6145	8	SCREW
25	9432	4	SCREW
26	6488-08	1	BEARING HOUSING (INTERFACE END)
27	6488-11	1	SEAL, RING
28	9433	1	SCREW
29	6488-12	1	SPRINE
30	6488-36	2	SEAL (OUTBOARD)
31	-----	4	O-RING (#2-030 VITON)
32	6488-20	1	SHIM
33	9445	7	SCREW
34	6488-03	1	SHROUD C.W.END
35	4242	18	BOLT, HEX
36	9434	14	NUT, HEX
37	4219	48	WASHER
38	6488-18	1	ASSEMBLY, CASE
39	6488-21	1	SUPPORT BASE

CHARACTERISTIC SYMBOLS	REFERENCES	UNIT	DATE	BY
SYMMETRICALITY	PARALLELISM	PERPENDICULARITY	FORM	
FLATNESS	CHAMFER	ROUNDNESS	FINISH	
CIRCULAR RUNOUT	CONCENTRICITY	STRAIGHTNESS	AS NOTED	
ANGULAR RUNOUT	STAGNATION	CONCENTRICITY	APPROVED	
		CONCENTRICITY	DATE	
		STAGNATION	DATE	
		CONCENTRICITY	DATE	
		STAGNATION	DATE	
		CONCENTRICITY	DATE	
		STAGNATION	DATE	

SCALE	2:1	SHEET	1 OF 1
REV.	DESCRIPTION	DATE	BY
	BARBERCO STICKY-CELL CO.		
	CHAMBERLAIN ST 02145		
	R.I.T.		
	65,000 RPM		
	DRAWING NUMBER 6488-00		REV